

16+2+1 Gigabit PoE Switch

HW-01C19-V

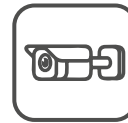
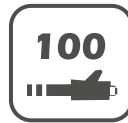

Main Feature:

- 16*1000Mbps PoE ports, 2*1000Mbps Uplink Port, 1*1000M SFP Port Combo.
- Support restrain network storm.
- Max Transmission distance up to 250m with PoE Power
- Built-in power supply
- Maximum power of single PoE port: 30W
- Maximum PoE power: 300W
- Adopts store-and-forward architecture
- Fanless, natural cooling, small, compact and quiet design, suitable for desktop or wall
- Support lightning protection 4kV

WATCHDOG

Auto-detect and restart IP camera timely if the camera is halted.

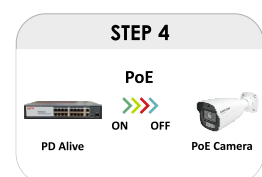
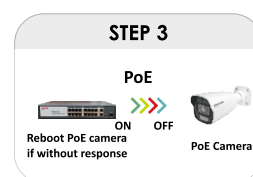
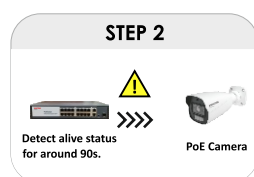

HAMSA INDIA

Address: C-112, Sector-65, Gautam Buddha Nagar, Noida - 201301 (U.P.)

*All picture and specifications are for reference only and are subject to change without prior notice.

www.amcomindia.com

Feature

Power Adapter Voltage
Consumption
PoE Ethernet Port
Ethernet Port, SFP Port
Transmission Distance
Transmission Medium
Network Standard
Switching Capacity
Packet Buffer Memory
Throughput
MAC Table
Packet Forwarding rate

Specification

AC 110V-240V
300W(52V 5.76A)
1-16 port:1000Mbps
Uplink port:10/100/1000Mbps, 1-SFP Port: 1000Mbps
100Mbps:0-100m / 10Mbps:0-250m / Uplink Port:0-80m
Cat5/5e/6 standard network cable
IEEE802.3/802.3u,IEEE802.3x,IEEE802.3ab
38Gbps
1Mbits
29.41Mbps
4K
10Mbps:14880pps/port, 100Mbps:1488000pps/port,
1000Mbps: 1488000pps/port
IEEE802.3af/at
End-Span(1/2 + ; 3/6 -)
af=15.4w,at=30w for each port
Power priority mechanism, fast and forward, MAC .
automatic learning and aging IEEE802.3X Full-duplex
and mode and back pressure for Half-duplex mode
LINK/ACT 100Mbps: PoE Status Indicator, Power Indicator, Extender
LED Indicator
Working temperature
Relative Humidity
Storage temperature
Dimension(L*W*H)
Color & Weight

Port Description

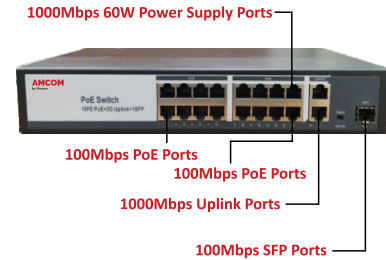

AC Ports

Typical Applications

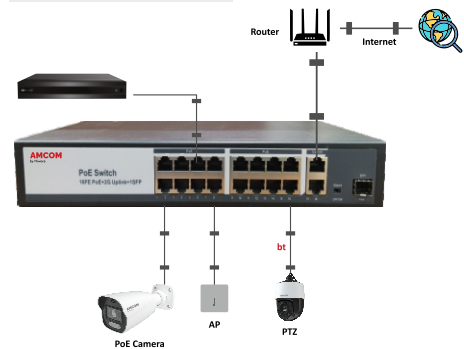

AVAILABLE MODEL

Model No.	HW-01C19-1
-----------	------------

Structure Diagrams

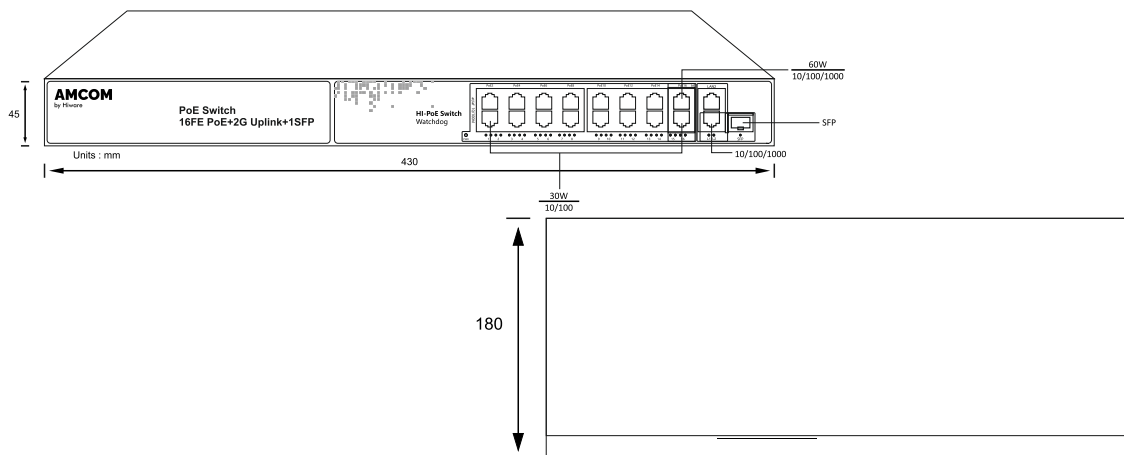

HAMSA INDIA

Address: C-112, Sector-65, Gautam Buddha Nagar, Noida - 201301 (U.P.)

*All picture and specifications are for reference only and are subject to change without prior notice.

www.amcomindia.com